

UC San Diego

ADVANCEMENT

Advancement Services

STAR Dashboard Overview

January 20, 2022

Office of Gift Policy Administration and Donor/Fund Stewardship

Kris Vasquez, Associate Director

Carla Velasquez, Senior Financial Analyst

Advancement Services Overview

MARLENE SHAVER
CFO, UC San Diego Foundation
Associate Vice Chancellor, Advancement Services

**Gift Policy Administration
and Donor/Gift Fund
Stewardship**

Corinne Cramer, Senior Director
Kris Vasquez, Associate Director
Carla Velasquez, Sr. Financial Analyst

**Gift and Foundation
Accounting**

Kierstin Sykes, Controller

**Foundation
Investment
Operations**

**Vlad Baytchev,
Manager**

Gift Services

Gail Robotta, Senior Director
Toni Drenon, Assistant Director

**Foundation Board
Operations**

Alice Sherman, Director

Objectives

- ✓ *Overview of gift funds and purpose of STAR*
- ✓ *General functionality and navigating STAR*
- ✓ *Live-demo*

Gift Fund Types

Endowment

- *All donations are invested – principal (represented as book value) cannot be expended*
- *Intended to last in perpetuity*
- *Annual payout distributed (~4%), (Foundation distributed monthly, Regents one lump-sum)*
- *Example: \$1M donation received → invested into endowment pool → produces annual payout of \$40K for benefitting department*

Current-Use (aka Fully Expendable) Funds

- *Intended to be expended immediately*
- *Does not have a principal amount and is not invested in the market*

Other Types:

***Fund Functioning as Endowment (FFE)
or Quasi Endowment***

Intermediate Total Return Fund (ITRF)

Gift Fund Number and Prefix Guide

Prefix of A through L indicates Foundation

Prefix of M through X indicates Regents

Endowment Example

Foundation

- **K1234 – Principal**
- **F1234 – Expendable**

Regents

- **T0123 – Expendable**

Current-Use Example

- **E1234 – Foundation**
- **RM123 - Regents**

Current-Use Funds

Foundation	Regents	Description
A	M	Unrestricted
E	R	Restricted

Endowments

Foundation	Regents	Description
K	W	Endowment Principal
F	T	Restricted Endowment Expendable
B	N	Unrestricted Endowment Expendable

Unrestricted FFE's

Foundation	Regents	Description
C		Unrestricted FFE Principal
D	P	Unrestricted FFE Expendable

Restricted FFE's

Foundation	Regents	Description
G		Restricted FFE Principal
H	U	Restricted FFE Expendable

Trusts/CGA's

Foundation	Regents	Description
L	X	Trusts/CGAs for Endowment Principal
J	V	Trusts/CGAs for Restricted Expendable

How do I access my Foundation gift funds?

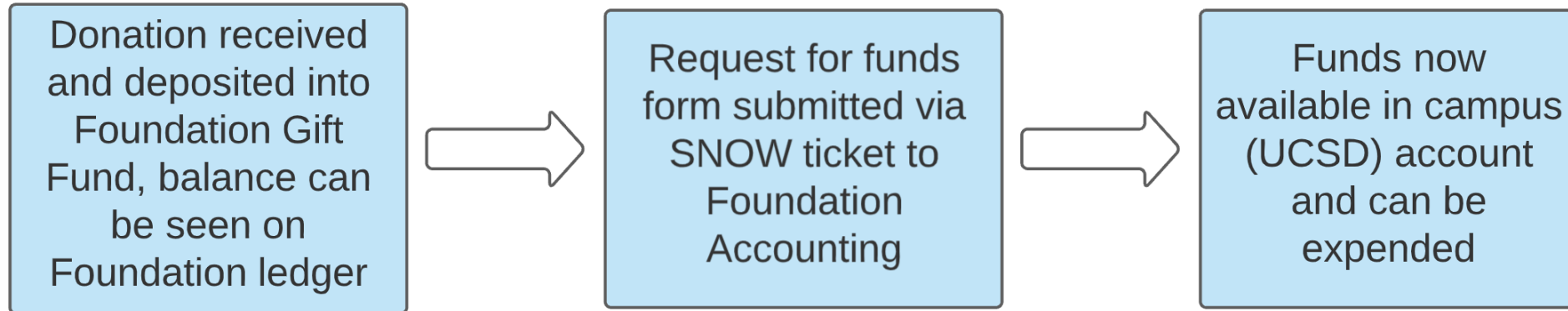

Additional notes to consider:

- Request for funds is not required for Regents gift funds
- Recurring transfers may also be setup with some exclusions (for example endowed chair gift funds)
- New gifts received in the current month will not be reflected in the overall balance until month-end close

Most common reasons to use STAR

- **Perform search of gift funds** by area, financial unit, fund holder/PI, or business officer to review overall gift fund balances.
- Review endowment **market value** and **book value**.
- Pull **endowment gift documents**, payout projection letters, or annual endowment reports
- Pull **list of donors** with gift amounts and dates (no personal information is included)

Comparing STAR and Gift Fund Panorama

	STAR DASHBOARD	BAH GIFT FUND PANORAMA
Lookup Gift Fund Balances	✓	✓
Lookup Gift Fund Balances by Project	✗	✓
See Foundation or Campus Ledger Activity - Review transfers and expenses	✗	✓
Create fund list and/or search by Fund Holder, Business Officer, Fund Type, Foundation/Regents, Etc.	✓	✗
Lookup gift fund documents for Endowments	✓	✗
Lookup donor and giving list	✓	✗

HOW TO ACCESS STAR

<https://foundation.ucsd.edu/>

- Under Financial Information



or

<https://blink.ucsd.edu/>

- Under tools -> business tools

The screenshot shows the UC San Diego Foundation website's STAR Dashboard. The page header includes the UC San Diego logo and navigation links: Board of Trustees, Committees & Councils, Endowment & Financials, Contacts, and GIVE NOW. The breadcrumb trail is HOME / Endowment & Financials / STAR Dashboard. A left sidebar menu lists: Endowment & Financials, Instructions for Wire Transfers & Stock Gifts, STAR Dashboard (highlighted), Investment Information, Gift Fund and Foundation Forms, Annual Financial Reports & Tax Information, and Frequently Asked Questions. The main content area is titled "STAR Dashboard" and contains a description of STAR (Stewardship, Transparency, Accountability, Reporting) as an online dashboard powered by Cognos. Below the description is a "STAR DASHBOARD LOGIN" section with a yellow button labeled "GO TO LOGIN PAGE" and a photograph of a sunset over a field. At the bottom, there is a list of expandable links: Login Instructions, Training, Frequently Asked Questions, Updates, and Contacts, followed by a link to a "STAR Troubleshooting Guide".

STAR: GIFT FUND BASIC SEARCH

*Search for your fund using the following criteria:

- Fund #
- Fund name or keywords
- Expendable Fund #

STAR Fund Search

Default Funds

Additional Funds *
Search for a fund by fund number, name, or keyword [Options](#)

[Select all](#) [Deselect all](#)

Legacy IFIS Fund
[Options](#)

[Select all](#) [Deselect all](#)

[Advanced Search Options](#)

STAR: GIFT FUND ADVANCED SEARCH

Example:
Search by Principal Investigator,
Chair Holder or Business Officer



Advanced Search Options

Or Criteria
The resulting list of funds will meet any of the criteria selected within this section
At least one criteria selection is required

Business Officer or Principal Investigator
Search for a BO/PI by name

[Options](#)

[Select all](#) [Deselect all](#)

STAR: GIFT FUND ADVANCED SEARCH

Example:

Search using Advancement
(VC Area, Division, Department)

or

Campus Financial Hierarchy
(from Oracle, by Financial Unit)

Division

- Health Sciences Vice Chancellor's Office
- Housing & Dining Services
- Human Resources
- Information Technology Svcs
- Institute of Molecular Medicine
- Intercollegiate Athletics
- Jacobs School of Engineering
- Medical Centers
- Medicine
- Neurosciences
- Nursing
- Obstetrics, Gynecology, and Reproductive Science
- Office of Equity, Diversity and Inclusion

[Select all](#) [Deselect all](#)

**Financial Unit Level 4
(Department)**

- Literature
- MW Administration
- Marine Science Office
- Marketing and Promotions
- Mathematics
- Mechanical and Aerospace Engineering
- Medical Education
- Medicine
- Medicine Nephrology
- Mens Baseball
- Mens Basketball
- Mens Cross Country
- Mens Soccer

[Select all](#) [Deselect all](#)

STAR: GIFT FUND ADVANCED SEARCH

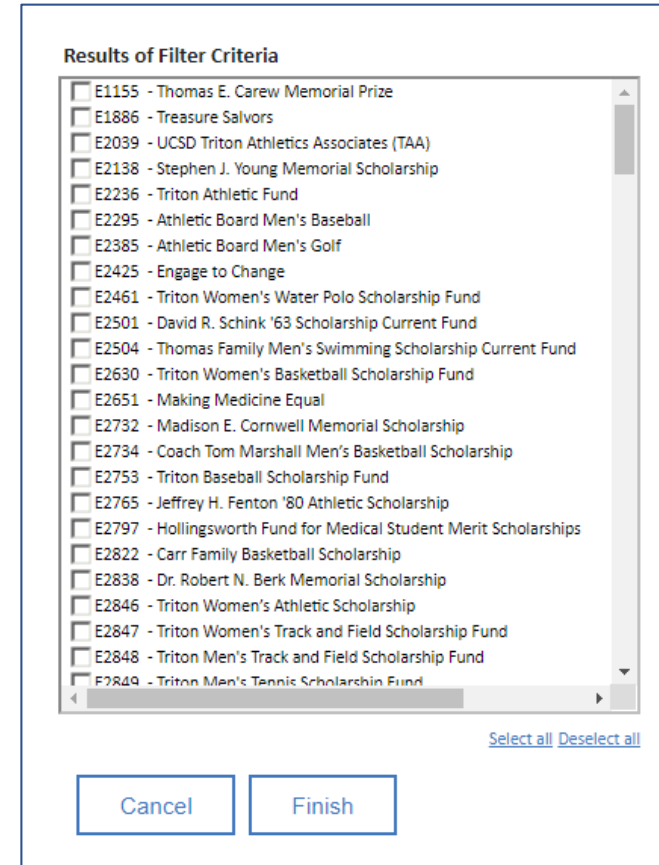
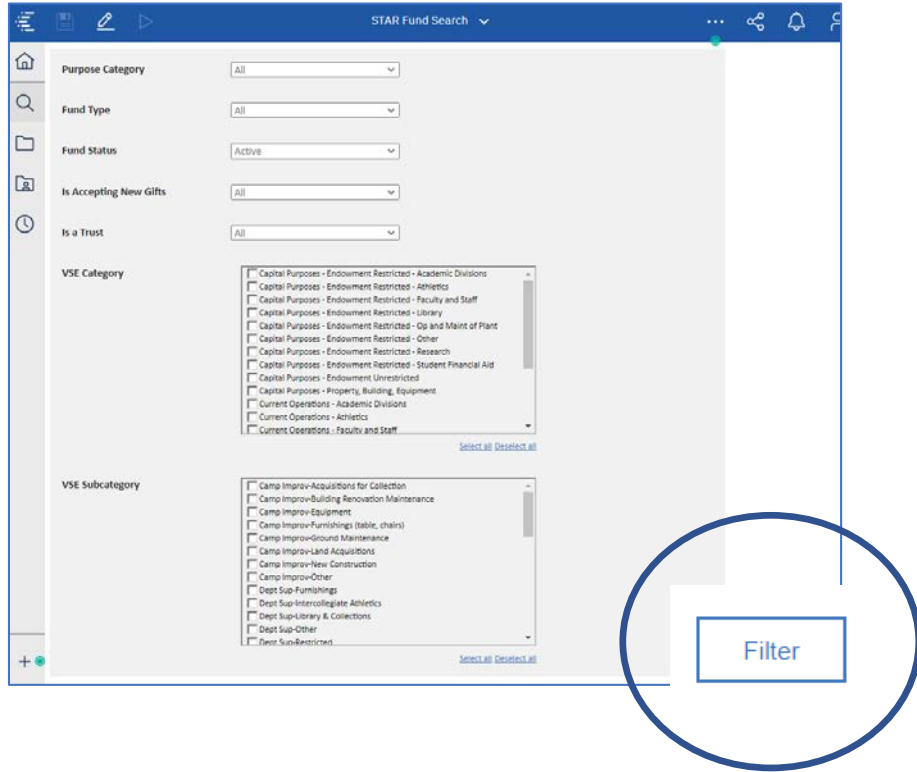

After selecting your criteria, don't forget to hit the 'Filter' button on the bottom right of the page!

Select Fund(s) and click Finish

STAR: GIFT FUND DASHBOARD

STAR Fund List

Fund Summary

	Book Value	Market Value	Foundation Expendable	Campus Expendable	Total Expendable
Foundation	\$348,742.81	\$496,342.24	\$6,784.12	\$9,577.36	\$16,361.48
Regents	\$0	No Data Available	\$0	\$160,866.28	\$160,866.28
Overall - Total	\$348,742.81	\$496,342.24	\$6,784.12	\$170,443.64	\$177,227.76

Foundation Funds

Fund Number	Expendable Fund	Fund Name	Fund Type	Book Value	Market Value	Foundation Expendable	Campus Expendable	Total Expendable
K4505	F4505	The Places You Will Go - Academic Connections Scholarship	Endowment Fund	\$348,742.81	\$496,342.24	\$0	\$0	\$0
E2755	E2755	Sally Ride Science @ UC San Diego	Current Expenditure	\$0	No Data Available	\$6,784.12	\$9,577.36	\$16,361.48
Overall - Total				\$348,742.81	\$496,342.24	\$6,784.12	\$9,577.36	\$16,361.48

Regents Funds

Fund Number	Expendable Fund	Fund Name	Fund Type	Book Value	Market Value	Foundation Expendable	Campus Expendable	Total Expendable
RN590	RN590	HS Cert Program	Current Expenditure	No Data Available	No Data Available	\$0	\$160,866.28	\$160,866.28
Overall - Total				\$0	\$0	\$0	\$160,866.28	\$160,866.28

*Campus Expendable is equivalent to Regents Expendable for dates prior to July 2020.

Fund Detail Page

STAR Fund Overview

Fund Number K1004
Expendable Fund F1004
Fund Name Victor C. Alderson Chair of Applied Ocean Science
Fund Purpose To support the teaching and research activities of the chairholder.

Fund Type Endowment Fund
Fund Use Dept Sup-Restricted-Endowed Chair
Legacy IFIS Fund 40712A
Is Accepting New Gifts No

VC Area Marine Sciences
Division SIO
Department Center for Atmospheric Science (CAS)
Financial Unit 2000020 - CASPO
Financial Unit Level 2 Marine Science
Financial Unit Level 3 Marine Sciences Research
Financial Unit Level 4 Ocean and Atmosphere
Principal Investigator Unfilled
Business Officer Ms. Anne J. Footer
Linked Funds No Linked Funds

New Overview New Search

Include All Dates
 Yes
 No

Date Range
 Jul 1, 2021
 Jan 31, 2022

Additional Info
[Foundation Ledger](#)
[Foundation Payout](#)
[Donor/Gift Detail - Condensed](#)
[Donor/Gift Detail - Detailed](#)

Documents
[Fund Information Sheet](#)
[Gift Documents](#)
[Endowment Projections](#) FY22
[Endowment Projections](#) FY21
[Endowment Projections](#) FY20
[Endowment Projections](#) FY19
[Endowment Projections](#) FY18

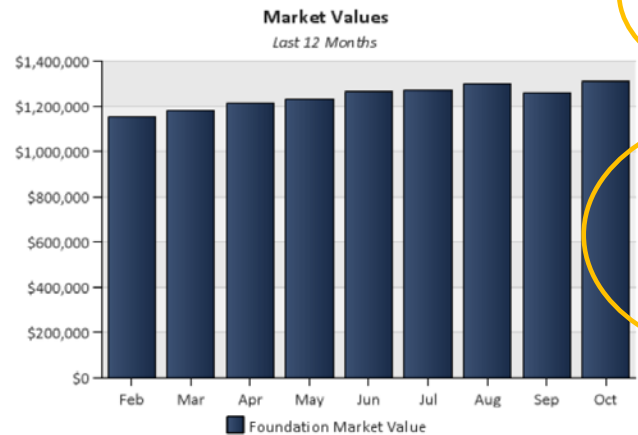
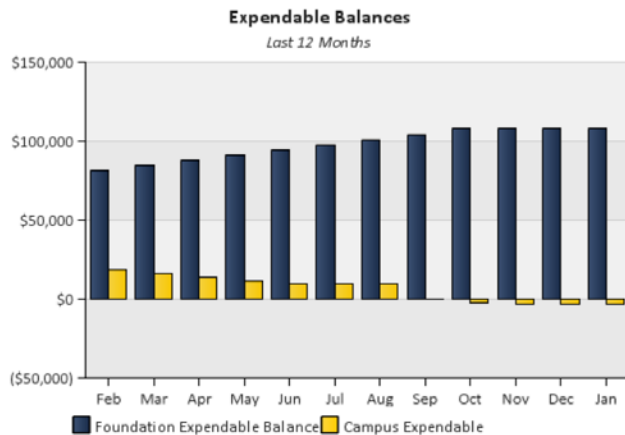

UC San Diego

ADVANCEMENT

Advancement Services

Live demo – let's jump in